

BRG-100

Product data H.F. X-ray Generator



BMI
BIOMEDICAL INTERNATIONAL

BRG-100

Product data **H.F. X-ray Generator**

X-Ray 'Generators-of-Choice'

For high-end hospital & clinical applications.

BRG-100 Generator

The 'heart' of the CPI system drives every major conventional / digital imaging system on the market today.

Pulsed & conventional fluoroscopy - all in one compact cabinet.

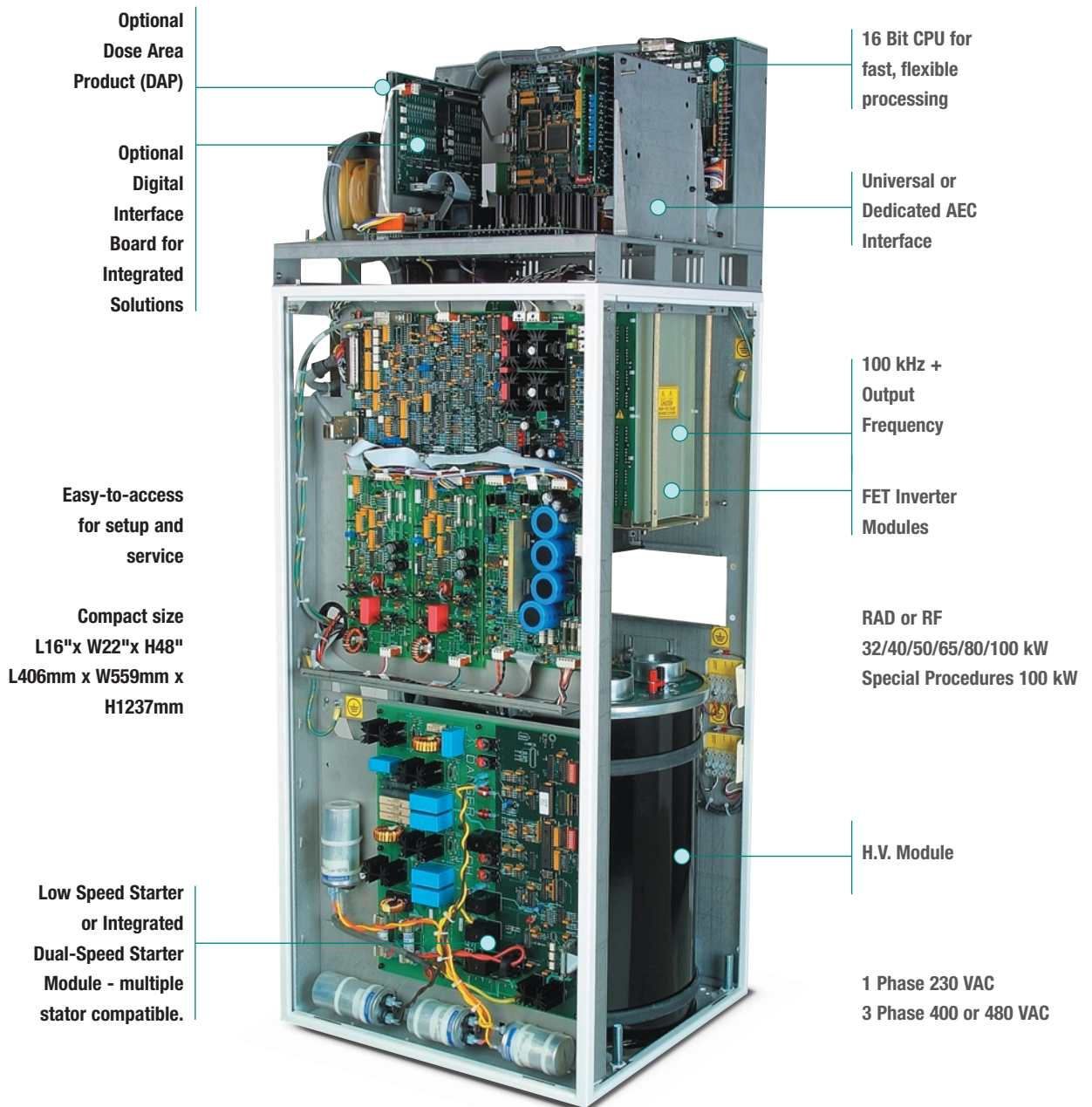

Technical data

BRG-100	32 kW*	42 kW*	50 kW	65 kW	80 kW	100 kW
Application	Radiographic	Radiographic or RF	Radiographic or RF	Radiographic or RF	Radiographic or RF	Radiographic or RF and Special Procedures
Generator Type	High Frequency 100kHz +	High Frequency 100 kHz +	High Frequency 100 kHz +	High Frequency 100 kHz +	High Frequency 100 kHz +	High Frequency 100 kHz +
kV (Radiographic)	40-150 kV	40-150 kV	40 -150 kV	40 -150 kV	40 -150 kV	40 -150 kV
kV (Fluoroscopic)	N/A	40-125 kV	40 -125 kV	40 -125 kV	40 -125 kV	40 -125 kV
mA Range RAD	10-400 mA	10-500 mA	10-630 mA	10-800 mA	10-1000 mA	10-1000 mA
mA Range - FLUORO	N/A	0.5-6.0 mA continuous	0.5-6.0 mA continuous	0.5-6.0 mA continuous	0.5-6.0 mA continuous	0.5-6.0 mA continuous
mAs Range Non AEC	0.5 - 630 mAs	0.5 - 630 mAs	0.5 -1000 mAs	0.5 -1000 mAs	0.5 -1000 mAs	0.5 -1000 mAs
Timer Range, sec.	0.001 - 6.3 sec. 1 Phase, 230 VAC	0.001 - 6.3 sec. 1 Phase, 230 VAC	0.001 - 6.3 sec.	0.001 - 6.3 sec.	0.001 - 6.3 sec.	0.001 - 6.3 sec.
Line Nominal/Phase	3 Phase 400 or 480 VAC	3 Phase 400 or 480 VAC	3 Phase 400 or 480 VAC	3 Phase 400 or 480 VAC	3 Phase 400 or 480 VAC	3 Phase 400 or 480 VAC,
Line Voltage Range	±10%	±10%	±10%	±10%	±10%	±10%
High Voltage Ripple (typ.)	<1 kV@ 100 kV	<1 kV@ 100 kV	<1 kV@ 100 kV	<1 kV@ 100 kV	<1 kV@ 100 kV	<1 kV@ 100 kV
Anatomical Programs	768 techniques	768 techniques	768 techniques	768 techniques	768 techniques	768 techniques
# of Image Receptors	6	6	6	6	6	6
Technique Selection	1. kV with AEC option 2. kV/mAs 3. kV/mA/Time	1. kV with AEC option 2. kV/mAs 3. kV/mA/Tme	1. kV with AEC option 2. kV/mAs 3. kV/mA/Tme	1. kV with AEC option 2. kV/mAs 3. kV/mA/Time	1. kV with AEC option 2. kV/mAs 3. kV/mA/Time	1. kV with AEC option 2. kV/mAs 3. kV/mA/Time
Documentation	Manual or CD	Manual or CD	Manual or CD	Manual or CD	Manual or CD	Manual or CD
GenWare™ Service Software	Yes	Yes	Yes	Yes	Yes	Yes
OPTIONS						
Touchscreen Console	Yes	Yes	Yes	Yes	Yes	Yes
Dual Speed Starter	Yes	Yes	Yes	Yes	Yes	Yes/Standard on SP
Optional Tube Stations	2nd Tube	2nd Tube	2nd Tube	2nd Tube	2nd Tube	2nd Tube/Standard on SP
AEC Interface	Ionization, PMT, or Solid State	Ionization, PMT, or Solid State	Ionization, PMT, or Solid State	Ionization, PMT, or Solid State	Ionization, PMT, or Solid State	Ionization, PMT, or Solid State
ABS Interface	N/A	PMT, Photo Diode, Video or Proportional DC	PMT, Photo Diode, Video or Proportional DC	PMT, Photo Diode, Video or Proportional DC	PMT, Photo Diode, Video or Proportional DC	PMT, Photo Diode, Video or Proportional DC
Continuous High Level Fluoro	N/A	up to 20 mA	up to 20 mA	up to 20 mA	up to 20 mA	up to 20 mA
DR/CR/R/F Digital	-	-	-	-	-	Infirm GoldOne® Swinglab
Imaging Interfaces						BRG-100 SP
Pulsed Fluoroscopy	N/A	Yes	Yes	Yes	Yes	Yes/Standard on SP
kV/mAs Stepping	N/A	Yes	Yes	Yes	Yes	Yes/Standard on SP
Cine	N/A	N/A	N/A	N/A	N/A	Yes/Standard on SP
Falling Load	Yes	Yes	Yes	Yes	Yes	Yes
Dose Area Product Readout (DAP)	Yes	Yes	Yes	Yes	Yes	Yes
Remote Fluoro Control	N/A	Yes	Yes	Yes	Yes	Yes
Pedestal Stand	Yes	Yes	Yes	Yes	Yes	Yes
Wall Mount	Yes	Yes	Yes	Yes	Yes	Yes
Exposure Hand-Switch	Yes	Yes	Yes	Yes	Yes	Yes/Standard on SP
3 Phase, 208 or 240 VAC with Line Adjusting Transformer	Yes	Yes	Yes	N/A	N/A	N/A

BRG-100 DIMENSION

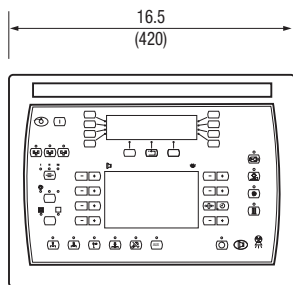
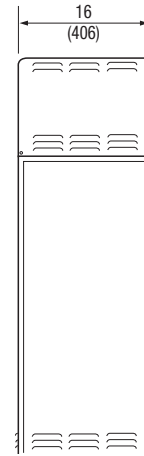
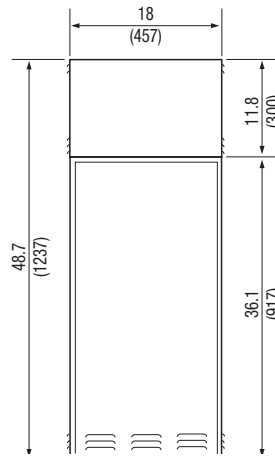
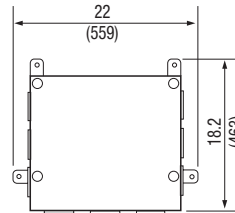

BRG-100 R/F CONSOLE

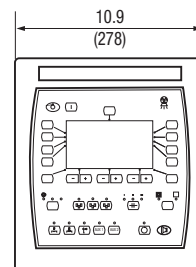
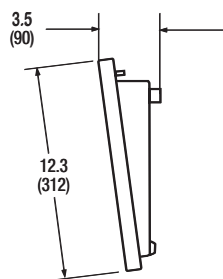

BRG-100 RAD CONSOLE

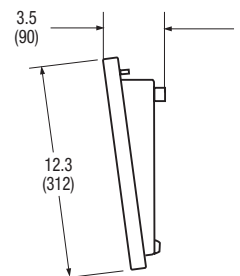

ESSE 3 Via Garibaldi 30
 14022 Castelnuovo D.B. (AT)
 tel +39 011 99 27 706
 fax +39 011 99 27 506
 e-mail esse3@tuttopmi.it
 web : www.4ci.com

